



Energy and Plant Technology (EPT)

CONSULTING, TECHNOLOGY, ENGINEERING AND CONSTRUCTION

Head Office: Hub 28 Prince Bode Adebowale Crescent, Lekki Phase 1, Lagos

Prompt and Successful Project Delivery

OUTLINE



OUR PROFILE



- ❑ EPT is a Project Consulting, Technology & EPC company specializing in the implementation and efficient project delivery within the Oil & Gas markets.
- ❑ EPT is a wholly indigenous company that strongly believes/supports the Nigerian Local Content Policy thrust.
- ❑ Our services to the Oil & Gas and allied sectors of the economy include:



ENGINEERING



PROCUREMENT



CONSTRUCTION



INSTALLATION



COMMISSIONING



OPERATION



MAINTENANCE

OUR PROFILE...



Vision

- ❖ To be the leading global contractor and employer of choice. This will be achieved by safely and consistently delivering successful projects and prompt services anywhere in the world with novelty



Mission

- ❖ To serve our customers, employees, shareholders and the communities by consistently delivering successful project promptly, any time, in any environment towards sustainable benefit to these stakeholders



Core Values

- ❖ Integrity
- ❖ Excellence
- ❖ Financial Stewardship
- ❖ Respect, Trust and Accountability
- ❖ Premium quality & HSE standards

OUR CAPABILITIES



- ❖ 3-Phase Separation, Crude Oil Dehydration Systems and Produced Water Treatment
- ❖ Facilities Maintenance & Computerized Maintenance Management System
- ❖ Field Services, Operations and Maintenance.
- ❖ Valves Repairs, Retrofitting and Remanufacturing
- ❖ De-sanding and Solid Handling
- ❖ Gas Processing
- ❖ Oil-Water and Gas-Liquid Separator Internals.
- ❖ Troubleshooting, Installation and Repairs for SCADA Equipment
- ❖ Professional trainings including:
 - Basic Operations Skills
 - Advanced 3-Phase Separator
 - Produced Water Treater & Process Certified Operator

PRODUCTION SEPARATOR DESIGN & FABRICATION



We have successfully designed, Installed and commissioned 30,000 BPD & 75,000 BPD 3-Phase Separators in Odidi Field and Jones Creek, OML 42

PRODUCTION SEPARATOR INTERNALS DESIGN

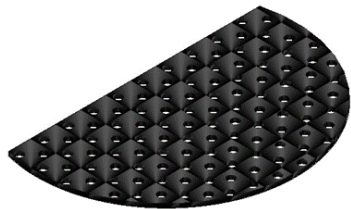

Coalescing Plate

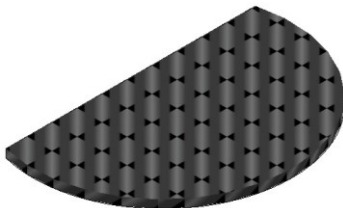

Weir Plate

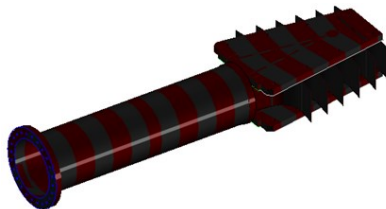

Inlet Diverter

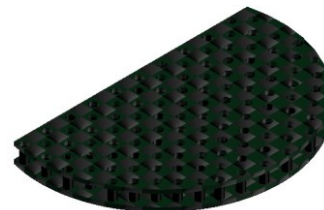

Gas Straightening Device



Vortex Breaker



Wave Breaker /
Inlet Distribution Plate



Mist Eliminator

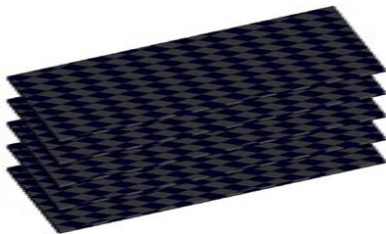

Defoaming Plate

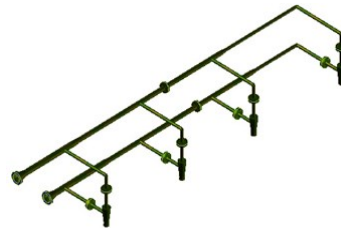

Sand Jetting Systems

We have Successfully Designed & Manufacture Production Separator Internals in Odidi Field and Jones Creek, OML 42

Our separator internals have up to 98% efficiency

SEPARATOR DESIGN AND CONSTRUCTION

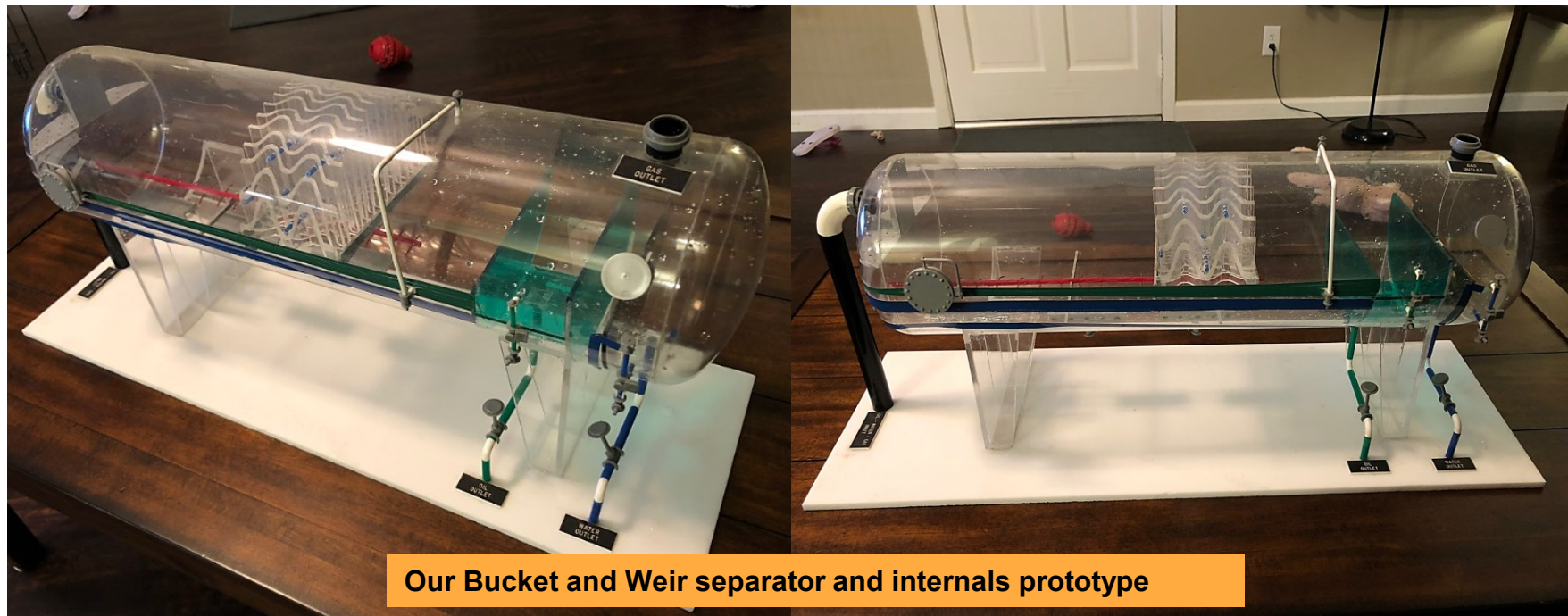

We Design and Construct Production Separators Prototype and associated Internals.

SEPARATOR INTERNALS PROTOTYPE



A. Wire Mesh Mist Eliminator

B. Vane Mist Eliminator

C. Defoaming/Coalescing Plates

We Design and Construct Separator Internals Prototypes

INSTALLATION OF SEPARATOR INTERNALS

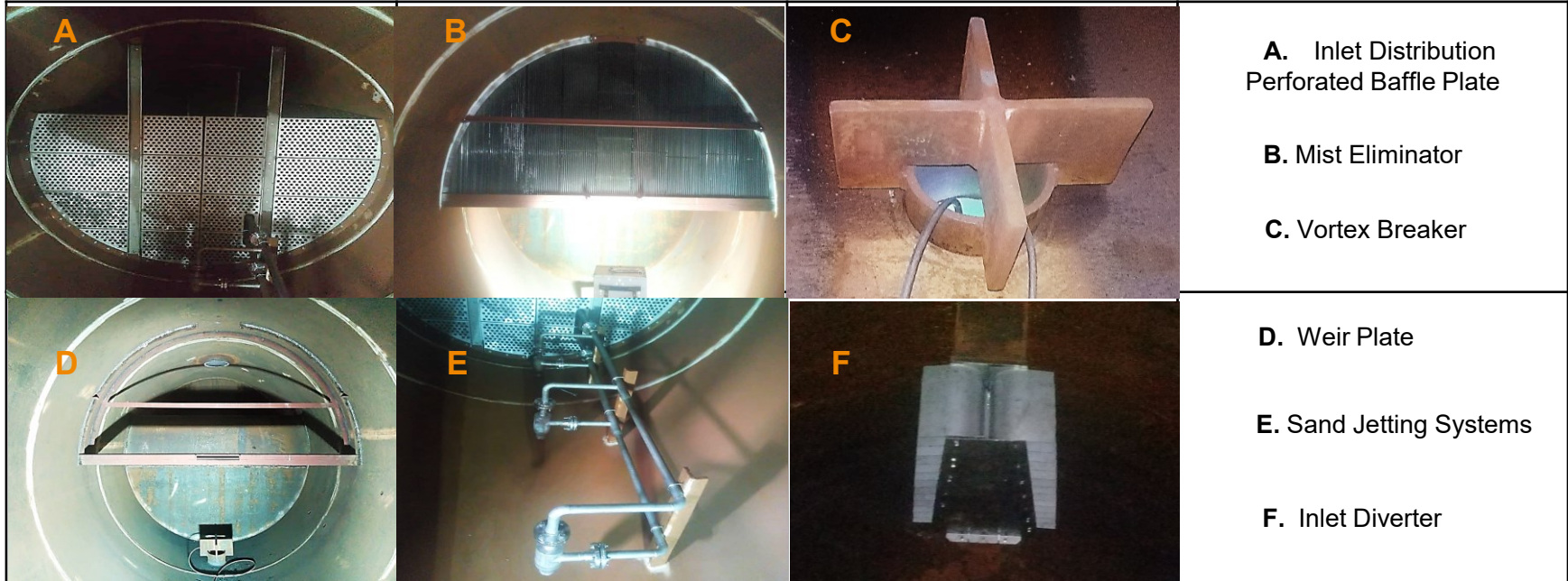

We Manufacture and Install 3-Phase Separator Internals in Odidi Field and Jones Creek, OML 42

CRUDE OIL & WATER TREATMENT TECHNOLOGY



Crude Oil Treatment Post Separation

- ☐ Heater Treaters
- ☐ Electrostatic Heater Treaters
- ☐ Electrostatic Treaters
- ☐ Crude Stabilizer
- ☐ Heat Exchangers
- ☐ Indirect Fired Heaters
- ☐ Direct Fired Heaters
- ☐ Chemical Injection Systems

Water Treatment Plant

- ☐ De-oiling Hydrocyclones
- ☐ Induced Gas Floatation
- ☐ Nutshell Media Filtration
- ☐ Backwash Filter
- ☐ Coalescers
- ☐ Regeneration Unit
- ☐ Decanter
- ☐ Cartridge Filtration / Polishers
- ☐ Chemical Injection Systems

Process Guarantee

Our crude oil and water treatment technologies assure <0.4% BS&W and <1.0ppm oil in water respectively

ELECTROSTATIC COALESCER INSTALLATION



Jones Creek Flow Station, OML 42



Odidi Flow Station, OML 42

We have Successfully Executed EPCIC, Startup support & Field Operational Training for a 75,000 BPD & 40,000 BPD Dual Automated Electrostatic Heater Treater, which we Operated for 6 Months and Handed Over to the Client.

PRODUCED WATER TREATMENT PLANT INSTALLATION



WEMCO/MIGF, OML 42



NUTSHELL FILTER, OML 42

EPCIC & Startup Support for a 20,000 BPD Produced Water Treatment Plant in Odidi Flow Station.

PRODUCED WATER TREATMENT PLANT INSTALLATION



WATERWOLF, OML 42



PUMP SKID, OML 42

EPCIC & Startup Support for a 20,000 BPD Produced Water Treatment Plant in Odidi Flow Station.

FACILITY MAINTENANCE MANAGEMENT & TRAINING



Computerized Maintenance Management System (CMMS)

- ❑ Asset tracking and plant scheduling
- ❑ Plant maintenance management
- ❑ Facility management and Job management
- ❑ Site and asset management, electronic forms (inspections and risk assessments)
- ❑ Advanced contractor management and job requests.
- ❑ Contract, budgeting and costing

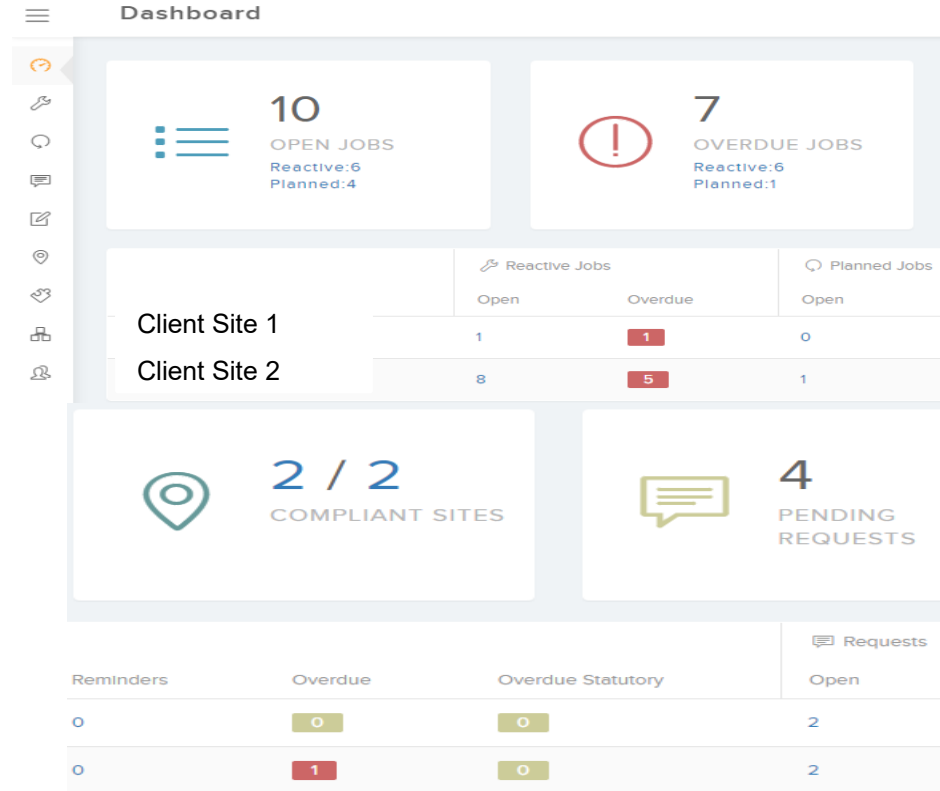

FACILITY MAINTENANCE MANAGEMENT & TRAINING



Training

- ☐ Basic Operations Skills
- ☐ Advanced 3-Phase Separator
- ☐ Produced Water Treater
- ☐ Process Certified Operator
- ☐ Introduction to Oil and Gas Industry
- ☐ Soft Skills; Time Management, Effective; Communication; Management; Project Management

We offer professional Oil and gas technology trainings championed by national and expatriate SME's



DE-SANDING AND SOLIDS HANDLING

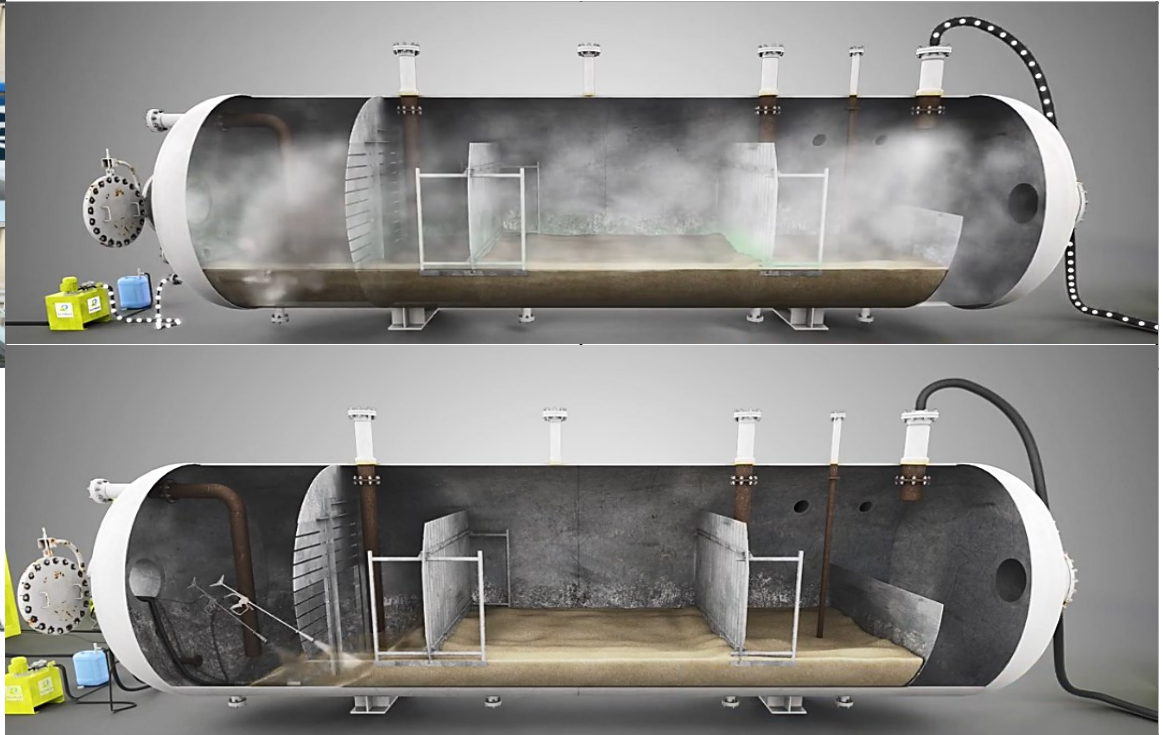
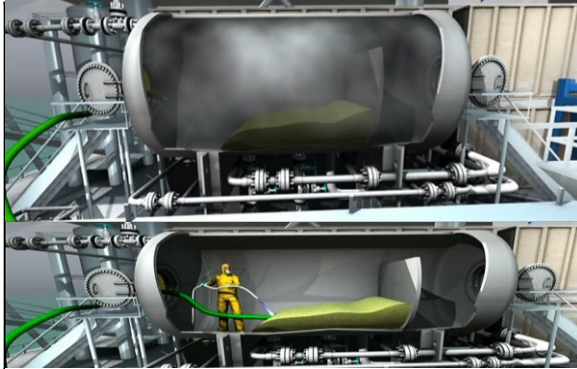

VALVES WORKSHOP



FABRICATION YARD



Hardlers for Placing Vessels



Cool Cut Machine for Cutting Pipe



CNC Machine for Plates Cutting



Rolling Machine for Folding Plate to Pipe Shape or Vessel



Turning Machine



Cutting Machine for Cutting Large Plate

OTHER EXECUTED PROJECTS WITH PARTNERS



EPF, Commissioning and Startup
Support of **HP Separator & Flare
System Package** in Otakikpo field,
OML 11

Provision of **Instrumentation Works
for Odidi and Jones Creek
Produced Water Projects**, OML42

**Hazard and Operability Study
for Test Separator Conversion
To Bulk Separator** In Odidi
Flow Station, OML 42.

EPF, Commissioning and Startup
Support of **High Pressure Separator
for Seplat Petroleum Development
Company Plc** in OML 4

Procurement and Commissioning of
Early Production Facility for OML
150

Engineering, Fabrication &
Installation of **Heat Shield** in
Odidi Field, OML 42

Installation of **Transformer** In Odidi
Flow Station, OML 42

Commissioning of **Odidi Field
Central Processing Facility**, OML
42

Provision of **Project
Management Services** for OML
**42 Produce Water Management
Project**

GAS PROCESSING

- ❑ Gas Dehydration and Desiccant Regeneration
- ❑ Sweetening and Amine Regeneration
- ❑ MEG Regeneration
- ❑ JT Plant
- ❑ Refrigeration and Cryogenics
- ❑ CO₂ and HG Removal
- ❑ Dew Point Control
- ❑ N₂ Generation
- ❑ High-Efficiency Compact Scrubbers



JOULE-THOMSON (JT) TREATMENT PLANT



20 MMSCFD in Port-Harcourt Fabrication Yard



80 MMSCFD JT Plant

COMMISSIONING & STARTUP

- ❑ Remote Installation and Pre-Commissioning
- ❑ On-site Start-up and Commissioning
- ❑ Verification / Validating Equipment Maintenance
- ❑ Visual / Physical Checks.
- ❑ Functional & Operational Tests
- ❑ Training & Qualification of Customer O&M Personnel



COMMISSIONING OF JONES CREEK ELECTROSTATIC HEATER TREATER

PRESSURE VESSEL & TANK FABRICATION



Pressure Vessels Design & Fabrication

- ☐ Separator vessels
- ☐ Flash drums
- ☐ Flare drums
- ☐ High-efficiency liquid/liquid separation internals
- ☐ High-efficiency gas/liquid separation internals
- ☐ High pressure and high specification vessels

General Fabrication

- ☐ Pipe racks
- ☐ Storage tanks
- ☐ Access platforms
- ☐ Process modules
- ☐ LNG storage tanks

DPR PERMITS

FEDERAL REPUBLIC OF NIGERIA
PERMIT TO OPERATE AS AN OIL INDUSTRY SERVICE COMPANY
SPECIALIZED CATEGORY

PERMIT NO: DPR-OGESP/18/52783/38/N1/50700

This Permit is hereby granted to
ENERGY AND PLANT TECHNOLOGY LIMITED.

of Plot 1679, Africa Re-Building Karimu Kotun
Victoria Island, Lagos, Nigeria

to render the service to the Oil Industry in the Category listed hereunder:
TECHNICAL CONSULTANCY
- FACILITY INSPECTION & MAINTENANCE SERVICE

This Permit expires on the Tuesday, December 24, 2019

Fee Paid: N. 250,000.00

Dated 24th day of December 20 18

Director of Petroleum Resources

This permit does not cover "Supply of Equipment/Response" in any guise

FEDERAL REPUBLIC OF NIGERIA
PERMIT TO OPERATE AS AN OIL INDUSTRY SERVICE COMPANY
SPECIALIZED CATEGORY

PERMIT NO: DPR-OGESP/18/54246/42/N1/50703

This Permit is hereby granted to
ENERGY AND PLANT TECHNOLOGY LIMITED.

of Plot 1679, Africa Re-Building Karimu Kotun
Victoria Island, Lagos, Nigeria

to render the service to the Oil Industry in the Category listed hereunder:
TECHNICAL CONSULTANCY
- PRODUCTION OPERATION & PROCESS MAINTENANCE

This Permit expires on the Tuesday, December 24, 2019

Fee Paid: N. 250,000.00

Dated 24th day of December 20 18

Director of Petroleum Resources

This permit does not cover "Supply of Equipment/Response" in any guise

FEDERAL REPUBLIC OF NIGERIA
PERMIT TO OPERATE AS AN OIL INDUSTRY SERVICE COMPANY
SPECIALIZED CATEGORY

PERMIT NO: DPR-OGESP/18/5689/56/N1/50701

This Permit is hereby granted to
ENERGY AND PLANT TECHNOLOGY LIMITED.

of Plot 1679, Africa Re-Building Karimu Kotun
Victoria Island, Lagos, Nigeria

to render the service to the Oil Industry in the Category listed hereunder:
MAJOR CONSTRUCTION SERVICES
- INSTALLATION AND UPGRADE OF ONSHORE & OFFSHORE PRODUCTION FACILITIES & PLATFORMS
- PROCESS FACILITIES

This Permit expires on the Friday, December 28, 2019

Fee Paid: N. 250,000.00

Dated 20th day of December 20 18

Director of Petroleum Resources

This permit does not cover "Supply of Equipment/Response" in any guise

FEDERAL REPUBLIC OF NIGERIA
PERMIT TO OPERATE AS AN OIL INDUSTRY SERVICE COMPANY
SPECIALIZED CATEGORY

PERMIT NO: DPR-OGESP/18/53128/28/N1/50704

This Permit is hereby granted to
ENERGY AND PLANT TECHNOLOGY LIMITED.

of Plot 1679, Africa Re-Building Karimu Kotun
Victoria Island, Lagos, Nigeria

to render the service to the Oil Industry in the Category listed hereunder:
SPECIAL TRANSPORTATION
- MARINE VESSEL SUPPLY AND OPERATION
- OFFSHORE OPERATION SUPPORT SERVICES/LOG MARINE SECURITY & EXCURSION MONITORING SERVICES/BOAT, BOAT, BARGE(S)

This Permit expires on the Tuesday, December 24, 2019

Fee Paid: N. 250,000.00

Dated 31st day of December 20 18

Director of Petroleum Resources

This permit does not cover "Supply of Equipment/Response" in any guise

FEDERAL REPUBLIC OF NIGERIA
PERMIT TO OPERATE AS AN OIL INDUSTRY SERVICE COMPANY
SPECIALIZED CATEGORY

PERMIT NO: DPR-OGESP/18/53589/2/N1/50702

This Permit is hereby granted to
ENERGY AND PLANT TECHNOLOGY LIMITED.

of Plot 1679, Africa Re-Building Karimu Kotun
Victoria Island, Lagos, Nigeria

to render the service to the Oil Industry in the Category listed hereunder:
HEAVY DUTY EQUIPMENT SUPPLY, INSTALLATION & MAINTENANCE
- SEPARATORS
- VALVES (12 INCHES & ABOVE)

This Permit expires on the Tuesday, December 24, 2019

Fee Paid: N. 250,000.00

Dated 24th day of December 20 18

Director of Petroleum Resources

This permit does not cover "Supply of Equipment/Response" in any guise

Facility Inspection & Maintenance Service

Production Operation & Process Maintenance

❖ Installation & Upgrade of Onshore and Offshore Production Facilities & Platform

❖ Process Facilities

❖ Marine Vessel Supply & Operation

❖ Offshore Operations Support Services

Heavy Duty Equipment Supply, Installation & Maintenance

❖ Separators

❖ Valves (12 Inches & Above)

PARTNERS & CLIENTS



YOUR FEEDBACK

